



ArcGIS: How to Get Licenses

USER GUIDE

How to Get Licenses

This guide is for UP users requiring licenses for ArcGIS Desktop and ArcGIS Pro Desktop. This is for UP students, faculty, and staff.

Users must ensure that they have already installed the software in their computer or laptop. The installer will be provided by the respective ArcGIS Persons-in-Charge (PICs) of the Constituent Universities (CUs).



How to Get Licenses for ArcGIS Pro Desktop Advanced

1. On your computer, open the ArcGIS Pro application. Click the link "Configure your licensing options."

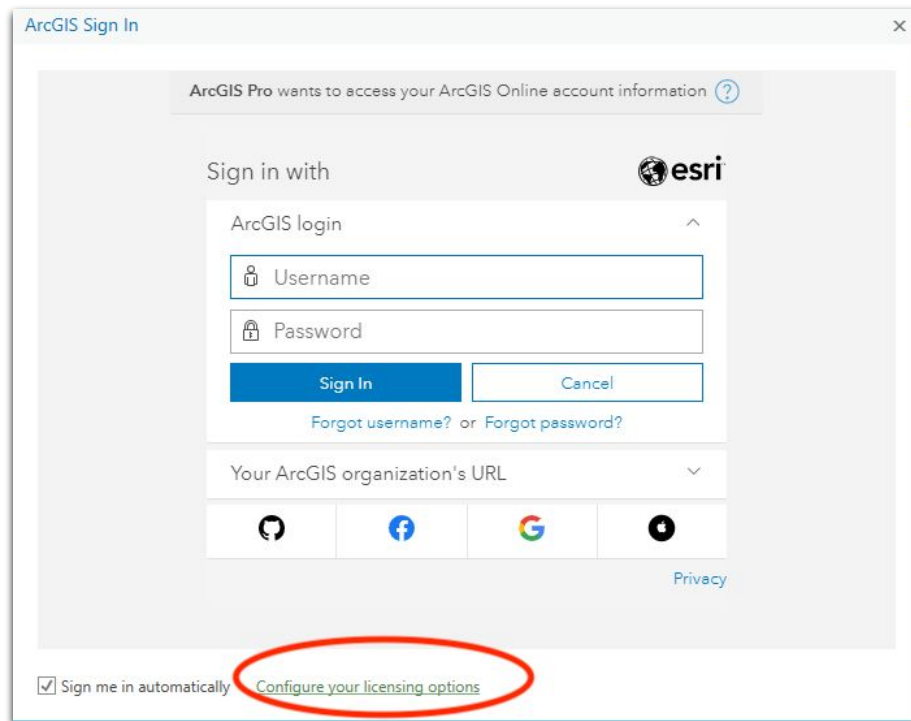

2. In the License Type field, select "Concurrent Use License."

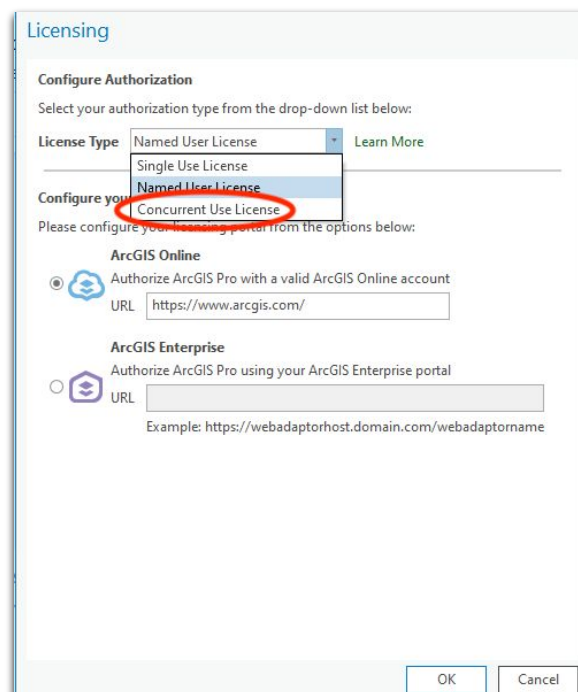

How to Get Licenses for ArcGIS Pro Desktop Advanced

3. In the License Manager, input the host name/domain name of your Constituent University's (CU) License Manager. Then click the "Refresh" button. Wait for it to load the available licenses.

Licensing

Configure Authorization
Select your authorization type from the drop-down list below:
License Type: Concurrent Use License [Learn More](#)

License Level
Select the Pro core product license level below:
Advanced Standard Basic

License Manager: [Add Backup](#)

Name	Licensed	Available Seats	Expires
ArcGIS Pro Advanced	<input type="checkbox"/>	0	N/A

4. Check the boxes of the licenses that you need to authorize. Then click the "OK" button.

Licensing

Configure Authorization
Select your authorization type from the drop-down list below:
License Type: Concurrent Use License [Learn More](#)

License Level
Select the Pro core product license level below:
Advanced Standard Basic

License Manager: arcgis.up.edu.ph [Add Backup](#)

Name	Licensed	Available Seats	Expires
ArcGIS Pro Advanced	<input checked="" type="checkbox"/>	40080	23/05/2022
3D Analyst	<input type="checkbox"/>	40080	23/05/2022
Aviation Airports	<input type="checkbox"/>	40080	23/05/2022
Aviation Charting	<input type="checkbox"/>	40080	23/05/2022
Bathymetry	<input type="checkbox"/>	0	N/A
Business Analyst	<input type="checkbox"/>	0	N/A
Data Interoperability	<input type="checkbox"/>	40080	23/05/2022
Data Reviewer	<input type="checkbox"/>	40080	23/05/2022
Defense Mapping	<input type="checkbox"/>	40080	23/05/2022
Geostatistical Analyst	<input type="checkbox"/>	40080	23/05/2022
Image Analyst	<input type="checkbox"/>	40080	23/05/2022
LocateXT	<input type="checkbox"/>	40080	23/05/2022

How to Get Licenses for ArcGIS Desktop Advanced

1. On your computer, open ArcGIS Administrator. Click the folder named "Desktop" and select the software product to be used. In the License Manager, set the port, and then the host name/domain name of the License Manager for your Constituent University (CU). Then, click the "OK" button.

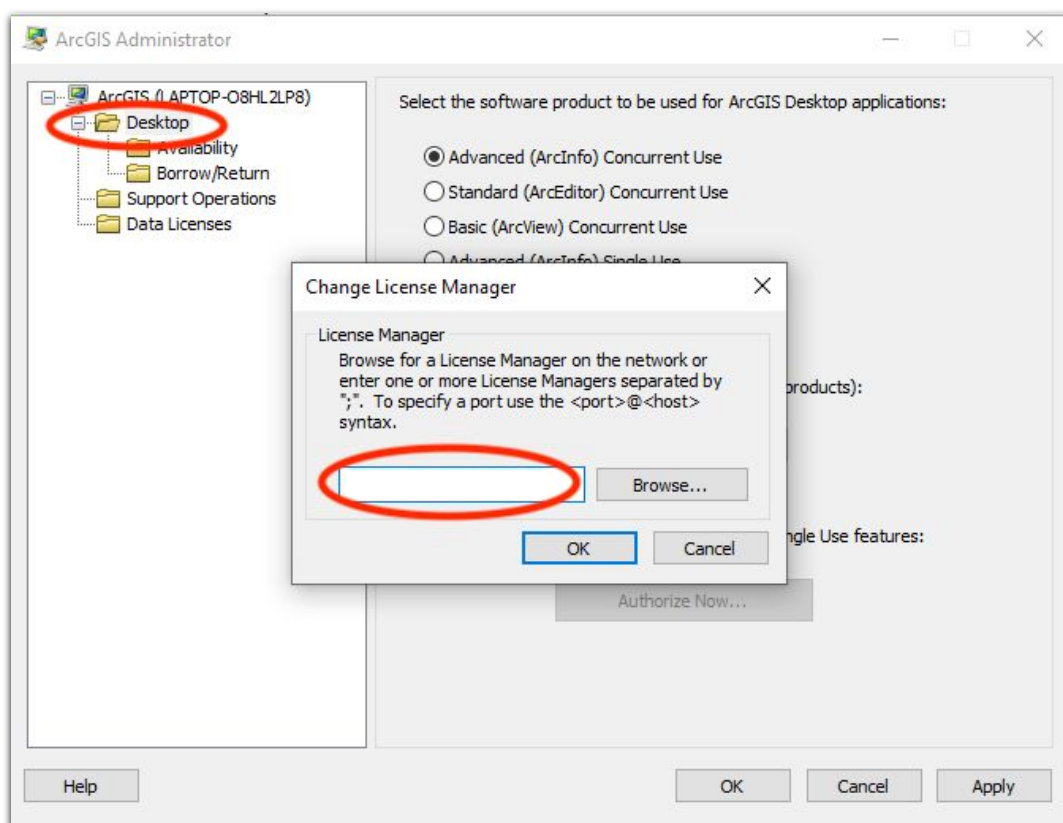

How to Get Licenses for ArcGIS Desktop Advanced

2. In the "Borrow/Return" folder, check the boxes of the licenses that you need to authorize. Then click the "OK" button.

